



# vraj **G**opi greens

*A Premium Villas*

*@ New Shilaj*

LUXURY SURROUNDED BY NATURE

**4 BHK**  
**PREMIUM VILLAS**

Project By

**GOPI**  
GROUP

office

Gopi House", Gift city circle -  
towards Shahpur village, Gift city,  
Gandhinagar (Gujarat)  
India Pin code - 382355  
[M] +91 99099 97515

Site Address :-

Vraj Gopi Greens, B/h. Electrotherm, New Shilaj Road,  
Palodia, Ahmedabad [Gujarat] India

Contact: +91 98250 47515, +91 63518 60246

E-mail: [info@gopiinfrastructure.com](mailto:info@gopiinfrastructure.com)

Website: [www.gopiinfrastructure.com](http://www.gopiinfrastructure.com)



Perfectly placed, right on the edge of Cosmopolitan western limits of AMC and in the most desirable village of Palodiya, We introduce our **VRAJGOPI GREENS "A Premium Villas"** residential bungalow scheme

Palodiya is now part of new AUDA Development Plan 2021 VRAJGOPI GREENS "A Premium Villas" offers you more space into your life, more quality and ality and luxury to your living...

Our creations are renowned for their architectural beauty and impeccable quality and with VRAJGOPI GREENS "A Premium Villas" we promise to continue our legacy...

VRAJGOPI GREENS "A Premium Villas" ENSURES a feeling of an aura of exclusivity around you...

welcome to vrajgopi greens "A Premium Villas", your immediate future home

## Key Plan





Your Companion For a Journey called

**LIFE**

## Layout Plan

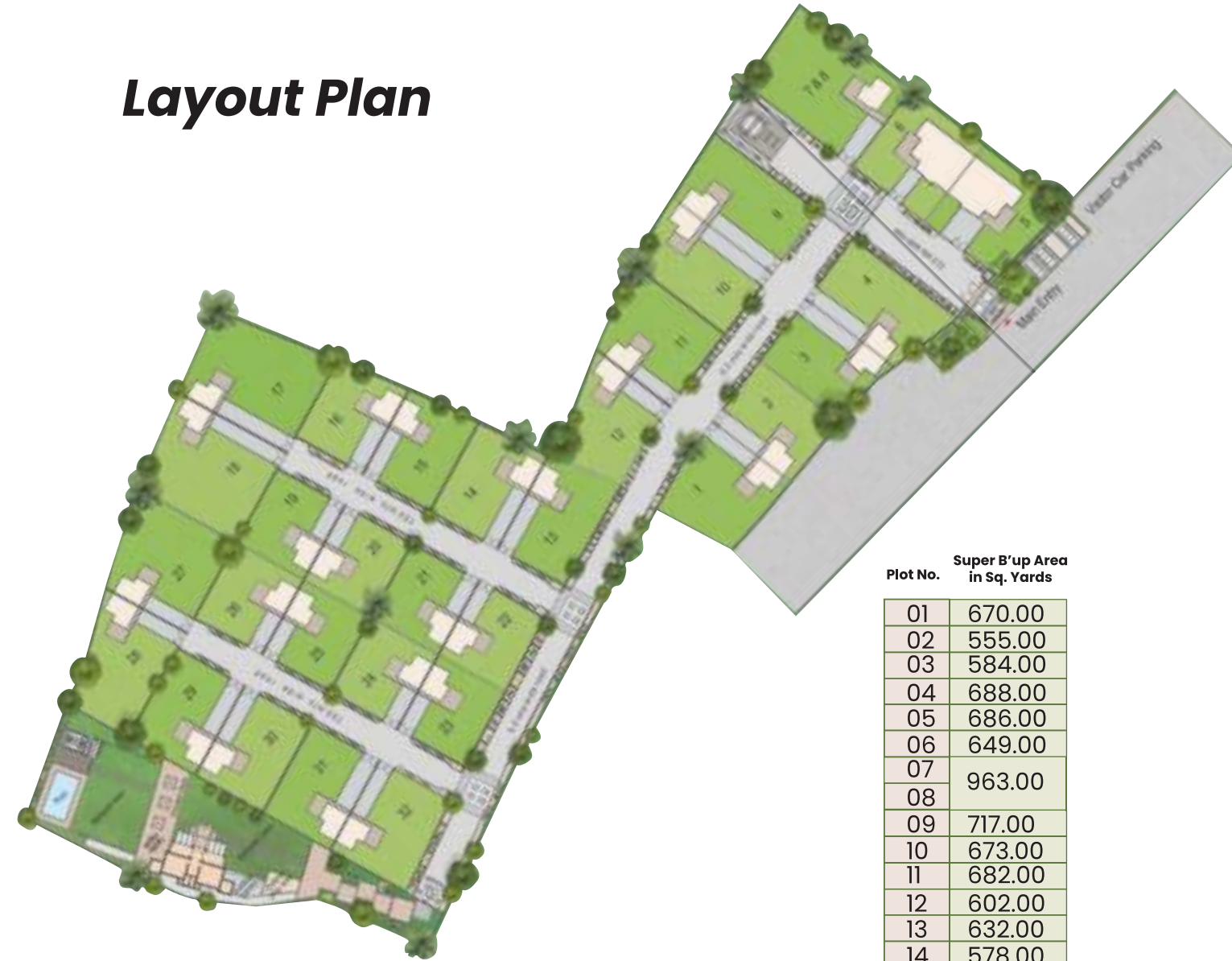

Plot No.	Super B'up Area in Sq. Yards
01	670.00
02	555.00
03	584.00
04	688.00
05	686.00
06	649.00
07	963.00
08	
09	717.00
10	673.00
11	682.00
12	602.00
13	632.00
14	578.00
15	552.00
16	514.00
17	912.00
18	874.00
19	476.00
20	476.00
21	476.00
22	472.00
23	480.00
24	475.00
25	475.00
26	478.00
27	766.00
28	683.00
29	569.00
30	569.00
31	568.00
32	625.00

**NOTE:**

This brochure is not a binding document and is meant only for display purpose.

Rights of altering the specifications and design are reserved with the project consultant.

Plot areas may vary subject to final survey.

Plans and Layouts are subject to amendments and approvals by relevant authorities.

Registration, GEB and other Govt. taxes and Maintenance charges would be borne by the members.

Subject to Ahmedabad jurisdiction.

**\*Plot area may vary**



**Important landmarks and distances:**



SP Ring Road: 4.5Km  
 Aranya Farms: 0.5 km  
 Arjun Farms : 1.5 km  
 DPS School : 2.0 km

- ONLY 32 PLOTS: FULLY DEVELOPED GATED COMMUNITY
- AMPLE OF GREEN ALL AROUND
- ULTRA MODERN FULLY EQUIPPED CLUB HOUSE
- CHILDREN PLAY AREA
- COMMON GARDEN & PARTY LAWN
- SWIMMING POOL AND SPLASH POOL
- RCC ROAD WITH PAVED WALKWAYS, PLANTATIONS, STREET AND THEMED LIGHTS
- GORGEOUS ENTRANCE GATE WITH SECURITY CABIN
- 40' WIDE ENTRANCE ROAD WITH WELL DESIGNED PLANTATIONS
- ALL PLOTS ARE WITH DESIGNER GATES AND SECURED COMPOUND WALL
- WATER CONNECTIVITY TO ALL PLOTS
- TITLE CLEAR, NA plots



**First Floor Plan**

This Brochure is not a binding document and is meant only for display purpose. Right of altering the specifications and design are reserved with the project consultant.



**Ground Floor Plan**



